

SP-200 LIRE SOLAR LED INSET RUNWAY EDGE LIGHT

MEDIUM INTENSITY



	<p>Compliance: ICAO Annex 14 Vol. I (7th. Edition, July 2016)</p>
---	--

APPLICATION

Runways edge for ICAO CAT I, II and III, FAA and military runways

TECHNICAL SPECIFICATIONS

Benefits

- 60000 hours LED rated life at full intensity, but over 100000 hours in field operating conditions
- In new installation, LED lights mean lower loads, lower size of CCRs and transformers, thus low life cycle costs
- The light output is variable like a traditional halogen lamp, as indicated by the FAA "Engineering Briefing No.67"
- Colour emitted directly by LEDs: absence of coloured filters ensures no energy losses and no colour shifts
- Fully compatible with existing AFL infrastructure
- Designed with simplicity allowing longer maintenance intervals and fewer spare parts
- No use of sealant to fix the prisms in the dome thanks to customized gaskets, making their replacement quick and easy
- No optical adjustment after LED module or prism replacement
- Valve for watertightness test after overhaul
- Operating with any topology of CCRs designed in compliance with IEC or FAA requirements

Compliances

- ICAO: Annex 14 - Volume I, 8th Edition, Fig. A2-9, A2-10
- EASA: CS-ADR-DSN, Book 1, Fig. U-13, U-14
- FAA: L-850C(L) AC150/5345-46 and EB No.67
- IEC: TS 61827
- NATO: STANAG 3316
- CAA: CAP 168
- IAAE: TP312
- CASA: Manual of Standards Part 139

Installation

- Suitable for 12" dia. bases
- Specific tools available for easy and precise installation

Performance

- Light output: 1.200 candela
- Autonomy at max intensity: 10 hrs
- Solar panel lifespan: 20 years
- Protection from radio disturbances: yes
- Radio control: 3.0 km
- The electronic is strong-built and highly resistant to shock and vibration
- Automatic adaptation to the frequency of the supply current
- A surge protection device is provided in the electronics as required by the FAA "Engineering Briefing No.67"
- Immediate detection of an internal fault
- 6.35 mm protrusion strongly reduces vibrations to aircrafts and to light itself, increasing its lifetime
- Dome smooth outer profile makes the light less sensitive to snowplough blades
- Bidirectional or unidirectional, 12" dia.
- Drop-forged dome and cast aluminium lower cover make the fitting sturdy, but lightweight too for easehandling in the field
- Light output practically not affected by heavy rainfall thanks to the shallow channel in front of the prism windows
- O-Ring placed outside the dome to avoid dirt deposits between light and base
- Over charging, over discharging, overload, short circuit protection
- Tools for installation and testing are provided
- Protection from radio disturbances
- Protection degree: IP68
- Temperature range: -55°C to +55°C

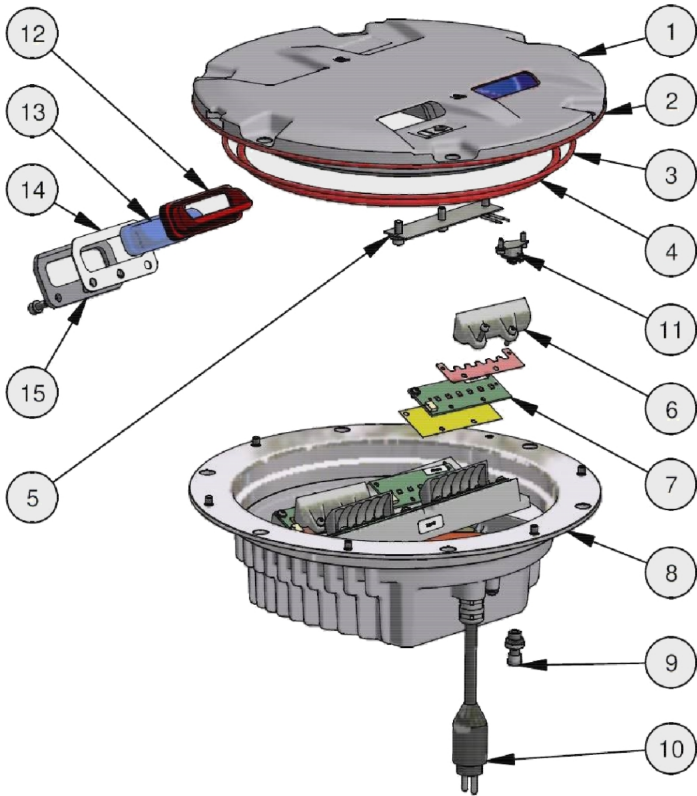

Main components of the lighting unit

- 1. Dome with prisms and gaskets
- 2. O-Ring for dome (external)
- 3. O-Ring for dome (internal)
- 4. O-Ring for lower cover
- 5. Arctic Kit heater
- 6. Reflector with hardware
- 7. LED module with accessories
- 8. Lower cover with electronic, plug and valve
- 9. Valve for watertightness test
- 10. FAA L-823 plug
- 11. Arctic Kit thermostat
- 12. Prism Gasket
- 13. Prism
- 14. Prism holder gasket
- 15. Mounting plate

PHOTOMETRIC PERFORMANCE

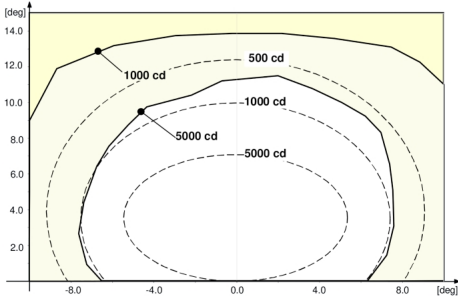

Fig. 1 ICAO A2-9 45 m – White

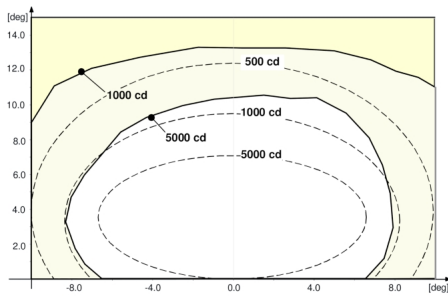

Fig. 2 ICAO A2-10 60 m – White

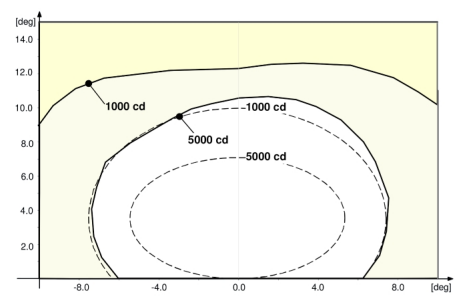

Fig. 3 FAA L-850C – White

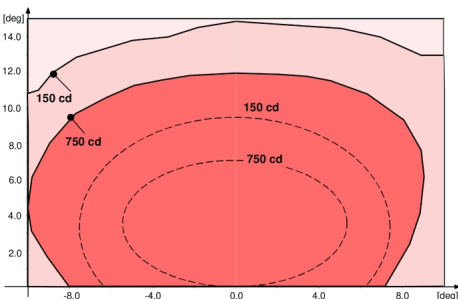

Fig. 4 FAA L-850C – Red

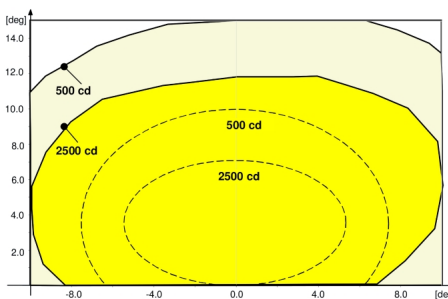

Fig. 5 FAA L-850C – Yellow

SHIPPING DATA

Item	Volume	Weight
Lighting Unit	0,22 m3	9,1 kg
Shallow base	0,22 m3	7,3 kg