

UR-201 CONTROL AND MONITORING UNIT

HARDWARE OF ALCMS

FEATURES

- Airfield Lighting Control Panel
- Automatic Failure Alarm via SMS
- Remote Activation of Airfield Lighting (via GSM, VHF)
- Remote Airfield Lighting Monitoring

CE COMPLIANCE

- 2014/53/EU Radio Equipment Directive
- 2011/65/EU and 2015/863 RoHS Directive



UR-201 Control & Monitoring Unit is a hardware element of S4GA ALCMS. It is designed to provide User with ability to remotely control and monitor S4GA Solar LED Runway Lighting.

UR-201 Unit can be optionally equipped with computer-based ALCMS offering real-time individual light monitoring (check ALCMS Basic, ALCMS Advanced product brochures)

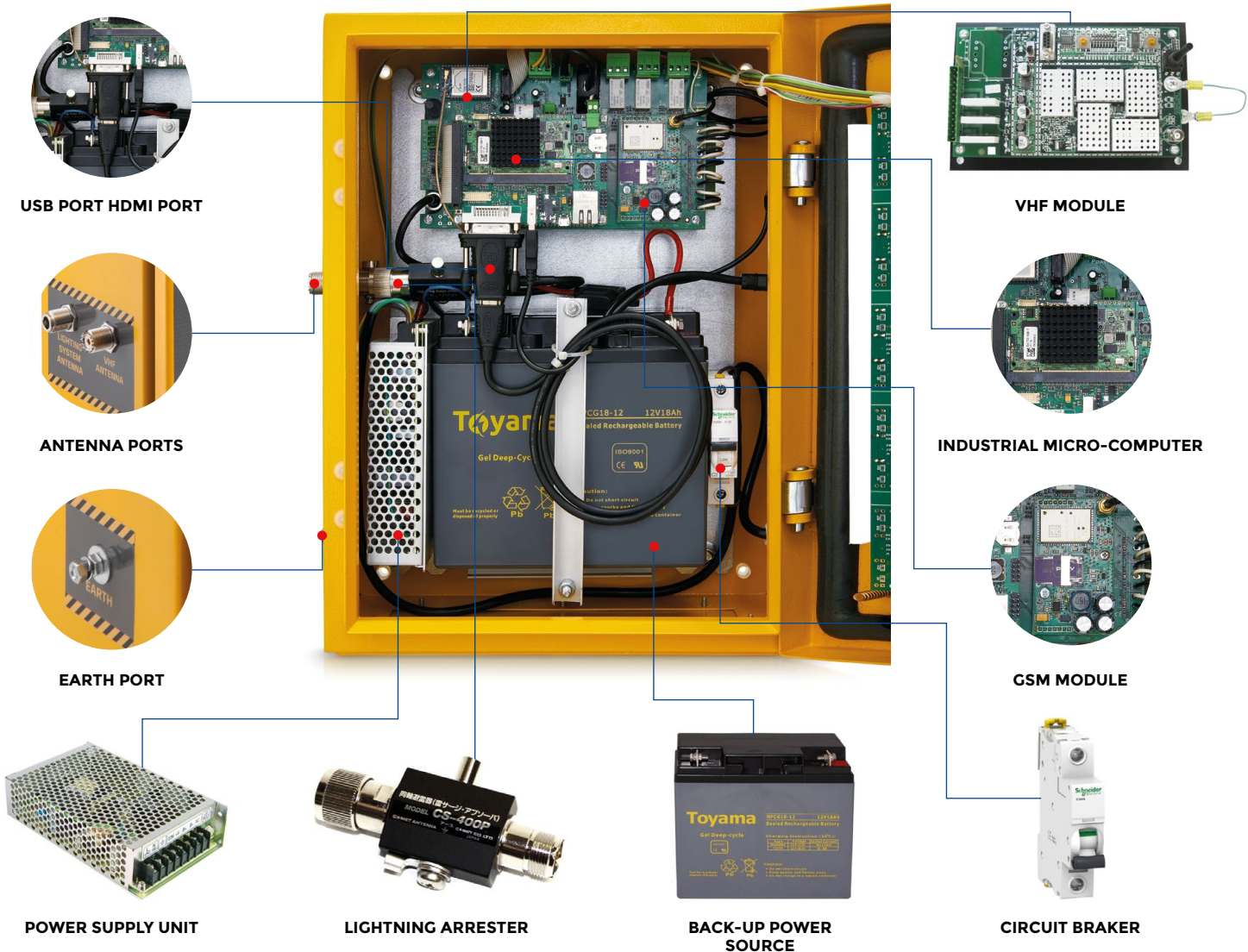

TECHNICAL SPECIFICATIONS

Control & Monitoring

Adjust lighting intensity	Yes
Select operating mode	Yes
Remote monitoring of the SP-401 unit(s) key parameters	Yes
Automatic failure alarm (via SMS)	Battery level of any lighting unit drops below 30%
	Any lighting unit stops responding to UR-201
	Power supply of UR-201 Units stops

Communication between Remote Control Unit and the Lights

Type	Wireless
Operating Range	Up to 1.500 m, relayed (each light is a repeater)
Radio transceiver (frequency/ power output)	Operating frequency: 868 MHz (optional 2.4 GHz or 433 Mhz) , 16 mW
External antenna	Yes

External Switches

Grouping of lights	Yes: up to 3 groups
Light intensity	Yes: 10%, 30%, 100% (for each group)
Operating mode	Yes: steady, flashing, NVG (for each group)
Timer	Yes
Remote activation of the Lights	Yes: GSM, VHF, GSM+VHF

Power Source

Primary power source	90 – 240 VAC
Back-up power source	Battery 18Ah, 12V
Back-up battery operating time	24 hrs

Remote Activation

VHF (pilot radio)	Yes
GSM (cell phone)	Yes

Lighting Protection

Separate lightning arrester	Yes
Lightning arrester grounding	Yes

External Ports

VHF antenna	Yes
Lighting system antenna	Yes
GSM antenna	Yes
USB	Yes
HDMI	Yes

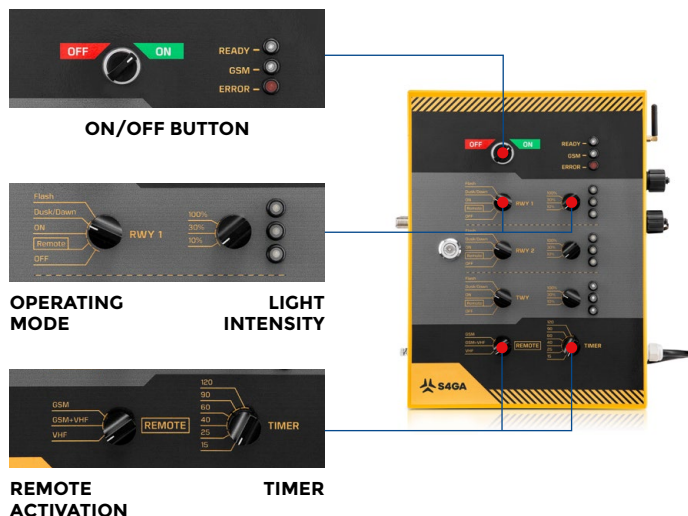

GSM Receiver

Receiver frequency	900, 1800 MHz
Recommended antenna	Outdoor / external
Operating mode	Gain: 2dBi, VSWR <1.8
	Polarization: vertical
External antenna connection type	SMA
Sim-card	GSM-provider is selected and supplied by the User according to the network coverage on site

VHF Scanner

Receiver frequency	118-136 MHz
Operation frequency	Programmable by S4GA
Transmission frequency	Scanner does not transmit signal
External antenna connection type	UC1, BNC
Recommended antenna	Base / outdoor
Base antenna radio characteristics	Maximum power: 100W FM
	Wind resistance: 60m/s
Base antenna signal cable	RF10, 10,3 mm diameter

Casing

UV resistance	Yes
Material	Powder coated steel
Operating Temperature	-20 / + 50 Degrees Celsius
Color	Aviation yellow

ACCESSORIES INCLUDED



CABLES

- VHF cable, length 10 m
- 868 MHz cable, length 10 m



ANTENNAS

- 868 MHz antenna
- GSM Antenna
- VHF antenna

SHIPPING DATA

Item	Dimensions of Package (LxWxH)	Gross Weight
UR-201 Unit	650 mm x 510 mm x 350 mm	18 kg
Accessories (cables, antennas)	1500 mm x 100 mm x 20 mm	8 kg