

L-861, L-861E & L-861SE LED

Medium Intensity Runway Light



COMPLIANCES

L-861(L), L-861E(L), L-861SE(L)
 FAA AC 150/5345-46 (current edition)
 FAA Engineering Brief 67D



ETL Certified

U.S. PATENT No. 9,206,961

Meets "Buy American" requirements.

ICAO: Annex 14, Vol. 1, para. 5.3.17

PRODUCT APPLICATION

The Navigate Series® L-861 LED elevated light fixtures are used to delineate the edges of airport runways and displaced thresholds.

The Navigate Series® L-861E LED elevated light fixtures are used to delineate airport runway thresholds/ends and displaced thresholds.

The Navigate Series® L-861SE LED elevated light fixtures are used to delineate the edges of airport runway thresholds/ends.

FEATURES

- Die cast aluminum body.
- Total Harmonic Distortion (THD) less than 1.1%.
- Less than 25VA at the highest step for the standard runway fixture.
- Fixture MTBF is greater than 50,000 hours.
- Complies with intensity requirements for 3-step and 5-step circuit.
- No Arctic Kit is ever needed on the standard runway fixture.
- Requires only a 20/25W isolation transformer for the standard runway fixture and SE type, and a 10/15W for the E type.

ELEVATED LIGHTS - 1.2

ORDERING INFORMATION

L-861 LED Order Number: 861 | L | X(X) | XX

Runway Edge Light

Fixture Type:
 861 = L-861
 L = LED

Color:
 W = Omnidirectional White
 Y = Omnidirectional Yellow
 WY = Bidirectional White/Yellow
 WR = Bidirectional White/Red
 YR = Bidirectional Yellow/Red
 GY = Bidirectional Green/Yellow
 WB = Unidirectional White*
 YB = Unidirectional Yellow*

Fixture Height:
 14 = 14 inches overall height (standard)
 24 = 24 inches overall height
 30 = 30 inches overall height

* Not FAA Certifiable

L-861E/SE LED Order Number: 861X(X) | L | XX | XX | X

**Runway Threshold/End
 Displaced Threshold Light**

Fixture Type:
 861E = L-861E
 861SE = L-861SE

L = LED

Color:
 GB = Unidirectional Green
 RG = Bidirectional Red/Green
 RR = Bidirectional Red/Red (E type only)

Fixture Height:
 14 = 14 inches overall height (standard)
 24 = 24 inches overall height
 30 = 30 inches overall height

0 = Without Arctic Kit
 1 = With Arctic Kit

RENEWAL PARTS

Description

Part Number

Globe

| | |
|-----------------------------|----------------|
| White | A1-32-0014-001 |
| Yellow | A1-32-0014-004 |
| White/Red | A1-32-0014-006 |
| Green/Yellow | A1-32-0014-007 |
| White/Yellow | A1-32-0014-008 |
| Yellow/Red | A1-32-0014-009 |
| Green/Red (E and SE only) | A1-32-0014-010 |
| Green/Blank (E and SE only) | A1-32-0014-011 |
| Red/Red (861E only) | A1-32-0014-002 |

Light Engine Assembly Options

| | |
|------------------------------------|----------------|
| 861, White | A3-06-3106-001 |
| 861, Green/Yellow | A3-06-3106-002 |
| 861E, Red/Green | A3-06-3114-001 |
| 861E, Red/Green, Arctic version | A3-06-3114-004 |
| 861E, Red/Red | A3-06-3114-002 |
| 861E, Red/Red, Arctic version | A3-06-3114-005 |
| 861E, Green/Blank | A3-06-3114-003 |
| 861E, Green/Blank, Arctic version | A3-06-3114-006 |
| 861SE, Red/Green | A3-06-3115-001 |
| 861SE, Red/Green, Arctic version | A3-06-3115-003 |
| 861SE, Green/Blank | A3-06-3115-002 |
| 861SE, Green/Blank, Arctic version | A3-06-3115-004 |

Band Clamp

A1-17-1027-003

O-Ring, 3 3/4 ID, 0.013 Thick

AS568A-154

Silicone Heater Ring (for Arctic version)

A1-01-0163-001

Fast Receptor Connector, 14-16 AWG, .187 x .032

A1-03-0260-001

Fixture Base

A1-17-1067-001

Strain Relief Bushing

D5975012-013

EMT

For 14-inch overall height

A1-17-1034-03

For 24-inch overall height

A1-17-1034-08

For 30-inch overall height

A1-17-1034-21

1.5-inch Frangible Coupling Kit

K1-02-0051-001

L-823 Cable Assembly

For 14-inch overall height

A2-17-0017-003

For 24-inch overall height

A2-17-0017-002

For 30-inch overall height

A2-17-0017-001

ACCESSORIES

Description

Part Number

Approx. Wt.

| | | |
|--|------------------|----------------|
| L-867 Base Can | AC2124-2Q2-00301 | 52 lb/23.6 kg |
| Stake Mount 1.5" hub | AW2205 | 12 lb/5.4 kg |
| L-823 Primary Connector Kit (8 AWG, .320"/.430") | 11174-01 | .335 lb/.15 kg |
| L-823 Complete Kit (8 AWG, .320"/.430") | 11805-01 | .335 lb/.15 kg |
| Heat Shrink Tubing Kit | A2-20-0089-001 | .5 lb/.23 kg |
| Base Plate | AP1935 | 8 lb/3.6 kg |
| 2" to 1.5" Baseplate Reducer | 10701994 | .5 lb/.23 kg |
| L-861 Leveling Tool | T3-01-0063-001 | |

EXPLODED VIEW

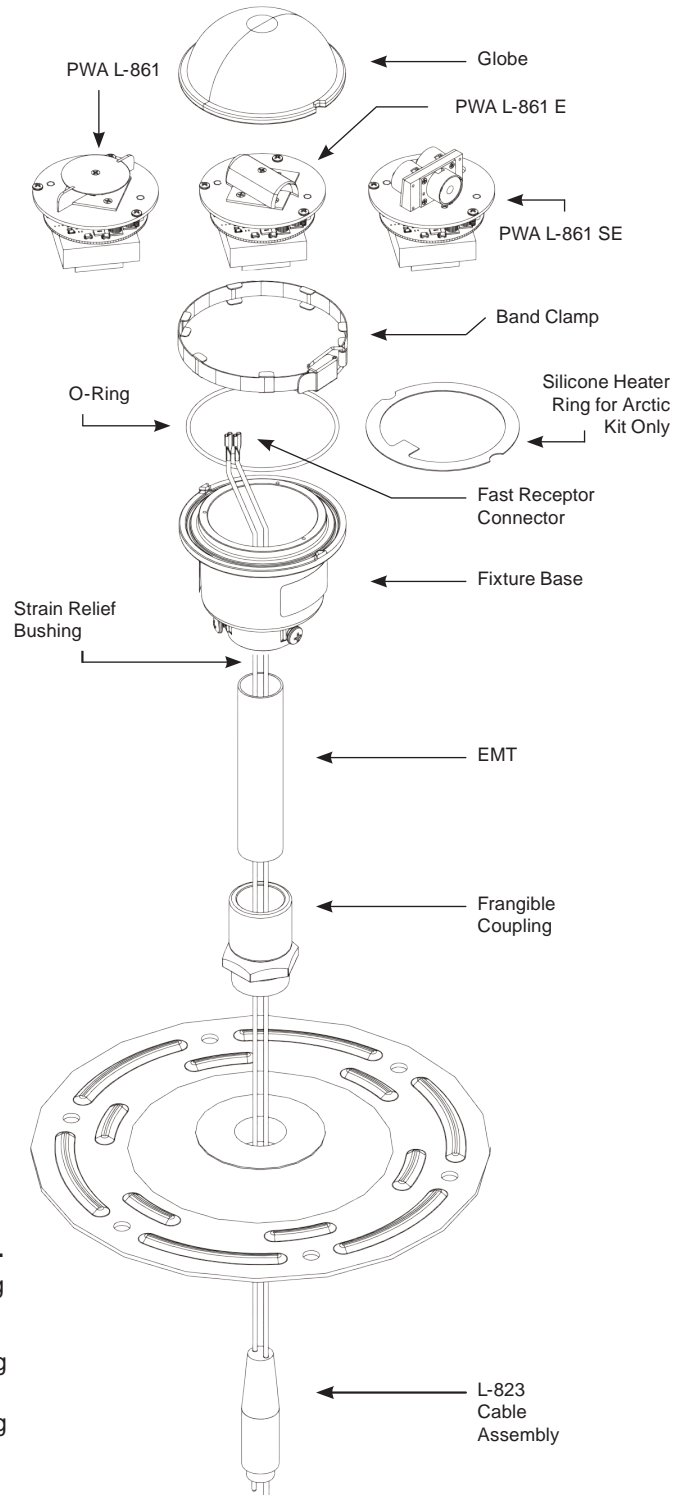

L-861 TRANSFORMER REQUIREMENTS

| L-861 Type | Series Circuit | Fixture Load | Required Transformer | Part Number |
|---------------|-----------------|--------------|----------------------|-------------|
| Uni & | 6.6A, 60Hz | 23.5VA | L-830-17 (20/25W) | 11729 |
| Bidirectional | 6.6A, 50Hz | 23.5VA | L-831-17 (20/25W) | 11733 |
| No Arctic Kit | 20 A/6.6A, 60Hz | 23.5VA | L-830-2 (30/45W) | 11681 |
| | 20A/6.6A, 50Hz | 23.5VA | L-831-2 (30/45W) | 11723 |

L-861E TRANSFORMER REQUIREMENTS

| L-861E Type | Series Circuit | Fixture Load | Required Transformer | Part Number |
|-----------------|-----------------|--------------|----------------------|-------------|
| Unidirectional | 6.6A, 60Hz | 11.55VA | L-830-16 (10/15W) | 11717 |
| No Arctic Kit | 6.6A, 50Hz | 11.55VA | L-831-16 (10/15W) | 11732 |
| | 20A/6.6A, 60Hz | 11.55VA | L-830-2 (30/45W) | 11681 |
| | 20A/6.6A, 50Hz | 11.55VA | L-831-2 (30/45W) | 11723 |
| Bidirectional | 6.6A, 60Hz | 14.0VA | L-830-16 (10/15W) | 11717 |
| No Arctic Kit | 6.6A, 50Hz | 14.0VA | L-831-16 (10/15W) | 11732 |
| | 20A/6.6A, 60Hz | 14.0VA | L-830-2 (30/45W) | 11681 |
| | 20A/6.6A, 50Hz | 14.0VA | L-831-2 (30/45W) | 11723 |
| Unidirectional | 6.6A, 60Hz | 26.1VA | L-830-1 (30/45W) | 11680 |
| With Arctic Kit | 6.6A, 50Hz | 26.1VA | L-831-1 (30/45W) | 11710 |
| | 20A/6.6A, 60Hz | 26.1VA | L-830-2 (30/45W) | 11681 |
| | 20A/6.6A, 50Hz | 26.1VA | L-831-2 (30/45W) | 11723 |
| Bidirectional | 6.6 A, 60Hz | 26.4VA | L-830-1 (30/45W) | 11680 |
| With Arctic Kit | 6.6 A, 50Hz | 26.4VA | L-831-1 (30/45W) | 11710 |
| | 20 A/6.6A, 60Hz | 26.4VA | L-830-2 (30/45W) | 11681 |
| | 20 A/6.6A, 50Hz | 26.4VA | L-831-2 (30/45W) | 11723 |

L-861SE TRANSFORMER REQUIREMENTS

| L-861SE Type | Series Circuit | Fixture Load | Required Transformer | Part Number |
|-----------------|----------------|--------------|----------------------|-------------|
| Unidirectional | 6.6A, 60Hz | 16.3VA | L-830-17 (20/25W) | 11729 |
| No Arctic Kit | 6.6A, 50Hz | 16.3VA | L-831-17 (20/25W) | 11733 |
| | 20A/6.6A, 60Hz | 16.3VA | L-830-2 (30/45W) | 11681 |
| | 20A/6.6A, 50Hz | 16.3VA | L-831-2 (30/45W) | 11723 |
| Bidirectional | 6.6A, 60Hz | 19.12VA | L-830-17 (20/25W) | 11729 |
| No Arctic Kit | 6.6A, 50Hz | 19.12VA | L-831-17 (20/25W) | 11733 |
| | 20A/6.6A, 60Hz | 19.12VA | L-830-2 (30/45W) | 11681 |
| | 20A/6.6A, 50Hz | 19.12VA | L-831-2 (30/45W) | 11723 |
| Unidirectional | 6.6A, 60Hz | 26.9VA | L-830-1 (30/45W) | 11680 |
| With Arctic Kit | 6.6A, 50Hz | 26.9VA | L-831-1 (30/45W) | 11710 |
| | 20A/6.6A, 60Hz | 26.9VA | L-830-2 (30/45W) | 11681 |
| | 20A/6.6A, 50Hz | 26.9VA | L-831-2 (30/45W) | 11723 |
| Bidirectional | 6.6A, 60Hz | 29.3VA | L-830-1 (30/45W) | 11680 |
| With Arctic Kit | 6.6A, 50Hz | 29.3VA | L-831-1 (30/45W) | 11710 |
| | 20A/6.6A, 60Hz | 29.3VA | L-830-2 (30/45W) | 11681 |
| | 20A/6.6A, 50Hz | 29.3VA | L-831-2 (30/45W) | 11723 |