

LERA

LED ELEVATED APPROACH, THRESHOLD, THRESHOLD WING BAR AND RUNWAY END LIGHT



COMPLIANCES

ICAO: Annex 14 - Volume I Fig. A2-1, A2-2, A2-3, A2-4, A2-8

EASA: CS-ADR-DSN Fig. U-5, U-6, U-7, U-8, U-12

FAA: L-862S AC150/5345-46

IEC: TS 61827

NATO: STANAG 3316

CAA: CAP 168 (GB)

TCCA: TP312 (CDN)

CASA: MOS 139 (AUS)

APPLICATIONS

Approach, Threshold, Threshold Wing Bar and Runway End for ICAO CAT I, II and III and military runways
Used for Stop Bar lighting on ICAO/FAA taxiways

BENEFITS

- 60000 hours LED rated life at full intensity, but over 100000 hours in field operating conditions
- In new installation, LED lights mean lower loads, lower size of CCRs and transformers, thus low life cycle costs
- The light output is variable like a traditional halogen lamp, as indicated by the FAA "Engineering Briefing No.67"
- Colour emitted directly by LEDs: absence of coloured filters ensures no energy losses and no colour shifts
- Fully compatible with existing AFL infrastructure*
- Designed with simplicity allowing longer maintenance intervals and fewer spare parts
- Transparent front protection mechanically fastened to the body by means of a suitable frame with silicone gasket, making its replacement quick and easy
- No optical adjustment after LED module or lens array replacement
- Operating with any topology of CCRs designed in compliance with IEC or FAA requirements

* For monitored fixtures, isolation transformer max size: 150VA

PERFORMANCES

- The electronic is strong-built and highly resistant to shock and vibration
- Automatic adaptation to the frequency of the supply current
- A surge protection device is provided in the electronics as required by the FAA "Engineering Briefing No.67"
- Immediate detection of an internal fault
- Lightweight and sturdy due to aluminium die-castings
- Powder coating surface finishing to provide good corrosion resistance
- Body balanced on a special support for proper and accurate horizontal and vertical aiming
- High jet blast resistance due to the small size of the Threshold and Runway End fixture, 310 mm high
- Protection degree: IP67
- Temperature range: -55°C to +55°C

INSTALLATION

- The fixture can be installed on pipe elbow or baseplate
- Specific tools available for easy and precise installation

PHOTOMETRIC PERFORMANCES

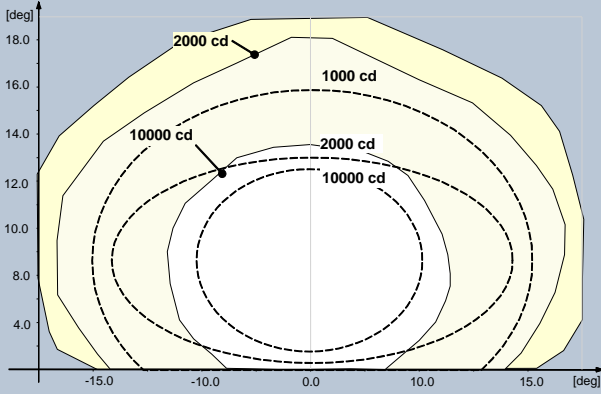

Fig. 1 ICAO Fig. A2-1 – White

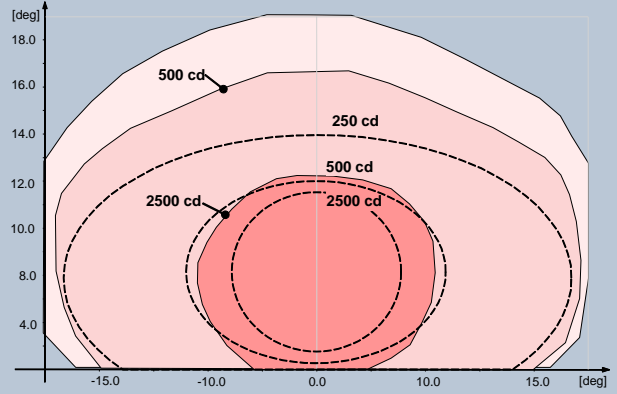

Fig. 2 ICAO Fig. A2-2 – Red

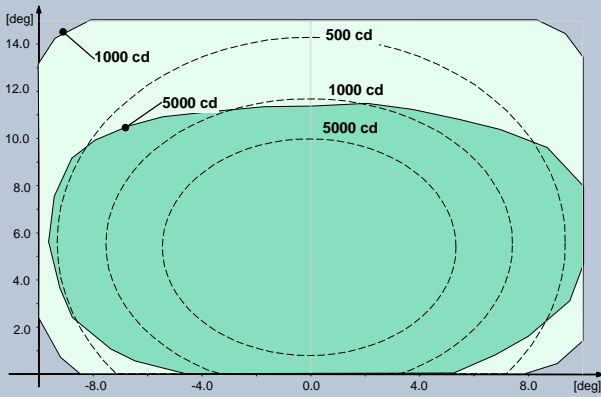

Fig. 3 ICAO Fig. A2-4 – Green

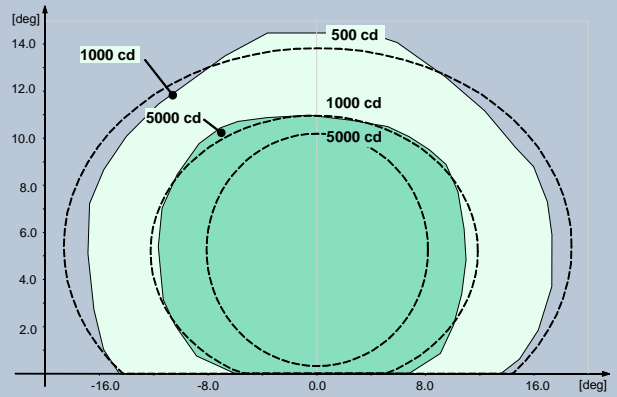

Fig. 4 ICAO Fig. A2-3 – Green

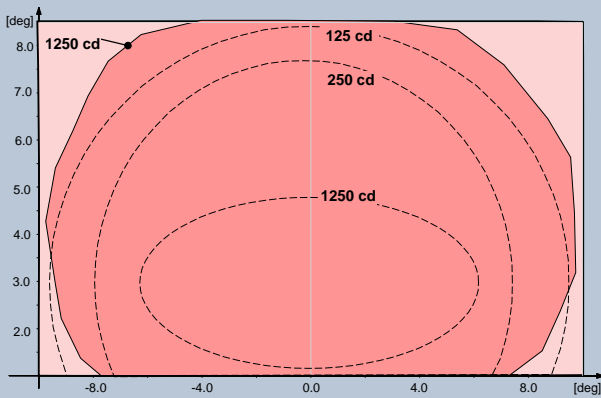

Fig. 5 ICAO Fig. A2-8 – Red

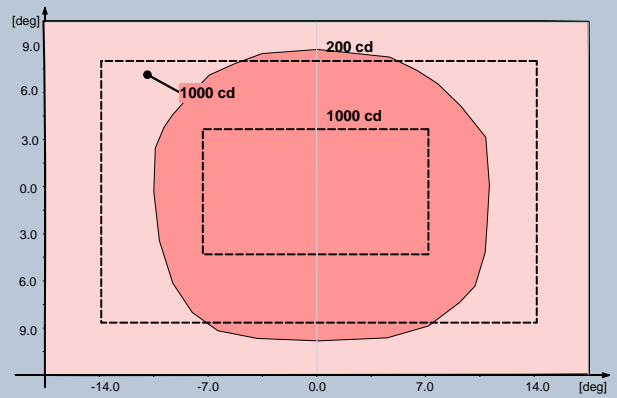
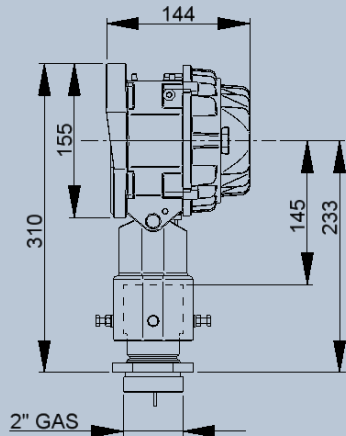

Fig. 6 FAA L-862S – Red

TABLES

POWER CONSUMPTION * (w/o Arctic Kit)	
Electrical System	1 Plug
Approach White	38VA
Approach Red	26VA
Threshold/Threshold Wing Bar Green	30VA
Runway End/FAA Stop Bar	20VA
ICAO Stop Bar	17VA
* Measured at 6.6 A	

POWER FACTOR		
Input Step	2.8 A	6.6 A
Power Factor	0.96	0.98



Configuration P-001

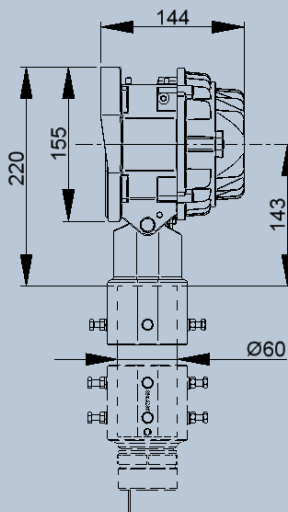

Configuration C-050

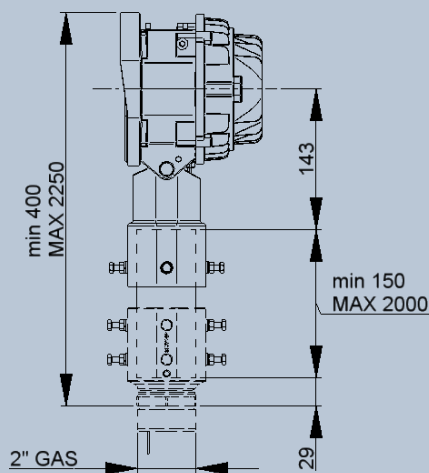

Configuration C-250

LERA - AC - P-001 - 0 - 0

Basic P/N: _____

Use Code: _____
(Refer to TABLE A)

Configuration: _____

P-001 = Fixture complete with breakable coupling
 C-050 = Fixture with special support and cable lead (L= 0.5 m)(*)
 C-250 = Semi-assembled fixture (AC and AR only)(*) (**)
 C-000 = Fixture without cable lead (*)

Monitoring: _____

0 = Without Monitoring
 M = With Monitoring

Arctic Kit: _____

0 = Without Arctic Kit

(*) Pole and breakable coupling must be ordered separately
 (**) This configuration is provided with cable lead of L = 2.5 m

TABLE A

CODE	USE	COLOUR
AC	Approach centreline and crossbars	WHITE
AR	Approach side row	RED
TG	Threshold	GREEN
WG	Threshold wing bar	GREEN
ER	Runway end	RED
SB	FAA Stop bar	RED
BA	ICAO Stop bar	RED

RENEWAL PARTS FOR LIGHT UNIT

- 1 Cover with electronic
- 2 Cover gasket
- 3 LED module support
- 4 LED module support gasket
- 5 LED module
- 6 Lens array for LED module
- 7 Body
- 8 Transparent front protection gasket
- 9 Transparent front protection
- 10 Transparent front protection holder plate (painted in the colour of the emitted light)
- 11 Vertical aiming adjusting device
- 12 Special support
- 13 FAA L-823 plug
- 14 Breakable coupling configuration P-001
- 15 Breakable coupling configuration C-050 or C-250

Refer to the relevant technical manual for the complete list

ACCESSORIES

- | | |
|----------|---|
| 013.0010 | Set of two ryton rings for receptacle support inside pipe elbow |
| 013.0008 | Galvanized steel pipe elbow with upper threaded end only (2" - 11 GAS thread) |
| 315.3210 | Galvanized steel pipe elbow with both threaded ends (2" - 11 GAS thread) |
| 315.1228 | Base L-867, Class IA, Size B, 24" Deep |
| 315.1062 | Baseplate for L-867 base with gasket and cable clamp (2" - 11 GAS thread) |
| 155.7200 | Breakable coupling for LERA configuration C-050 or C-250 |
| 315.3710 | Supporting pole (H = 150 mm) |
| 315.3711 | Supporting pole (H = 500 mm) |
| 315.3712 | Supporting pole (H = 1000 mm) |
| 315.3713 | Supporting pole (H = 1500 mm) |
| 315.3714 | Supporting pole (H = 2000 mm) |
| 332.4560 | Levelling and alignment device for light on supporting pole |
| 332.4571 | Support for device P/N 332.3240 |
| 332.3240 | |
| 798.0006 | Special tubular wrench 22 mm for bulkhead connector |

For any information about isolating transformers and connectors, please see the specific catalogue pages

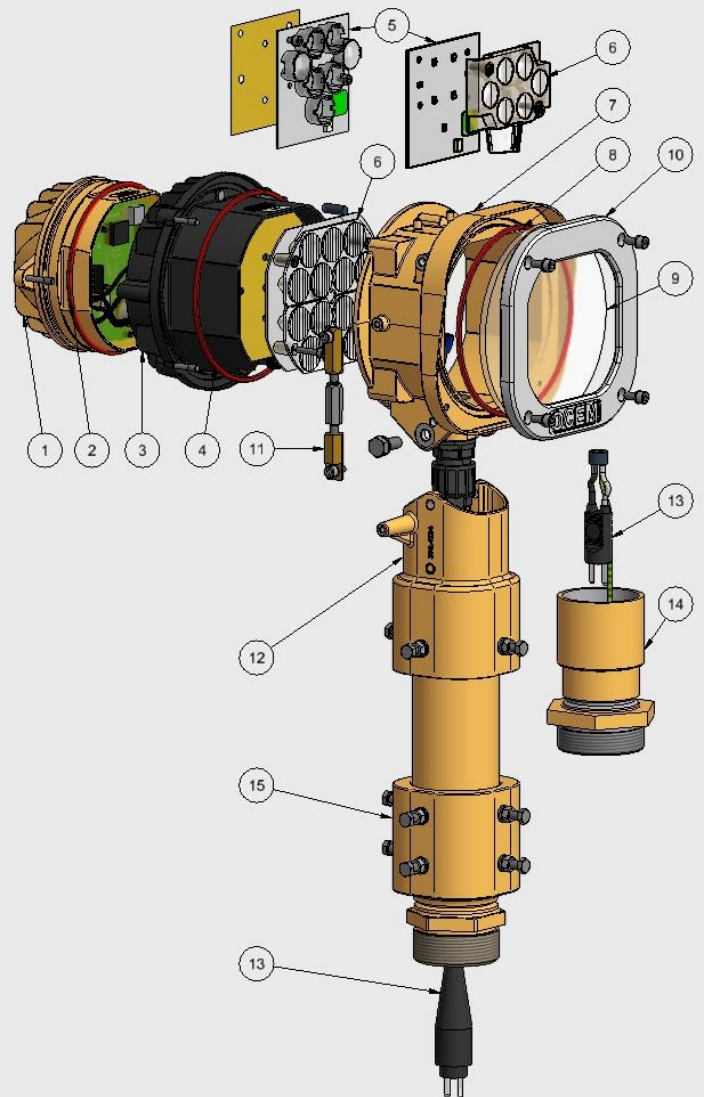
**Shipping Weights and Volumes**

	Light Type P-001	Light Type C-050	Light Type C-250
Weight (kg)	4.4	4.1	5.0
Volume (m³)	0.019	0.019	0.019

We reserve the right to change the design or specification data without notice

UC-PU-0304_EN Rev.B